

# Operation & Service Manual

## 300 SERIES **FLATBED**

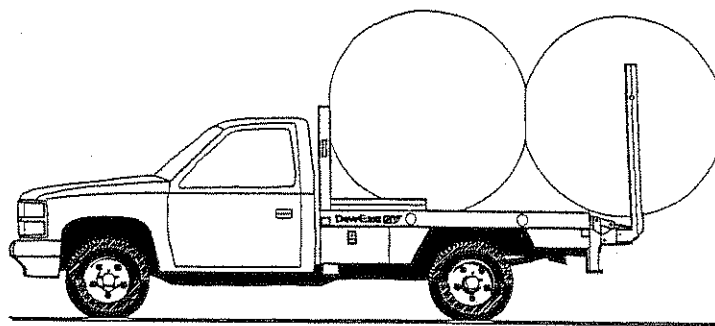

**Black Arm**

11 / 98

**DewEze** Manufacturing

Publication #200088

## INTRODUCTION

Thank you for purchasing a DewEze 300 Series Flatbed. We hope it provides you with many years of service. The Flatbed with live hydraulics allows it to be used for a wide range of farm and ranch chores. This manual is written as an aid to operating and maintaining your Flatbed.

## FOR YOUR RECORDS

Date of Purchase \_\_\_\_\_

Dealer's Name \_\_\_\_\_

Dealer's Phone \_\_\_\_\_

Serial Number \_\_\_\_\_

Following publication of this manual, certain changes in standard or optional equipment may have occurred which would not be included in these pages. Your DewEze dealer is the best source for up to date information.

DewEze Manufacturing reserves the right to change product specifications at any time without incurring obligation to provide such updates to previously manufactured units.

© 1998 DewEze Manufacturing  
151 E. Hwy. 160  
Harper, KS 67058

## CONTENTS

### OPERATION AND SERVICE

Introduction.....	ii
Warranty.....	2
Model identification and specifications .....	3
Safety symbols .....	4
Safety decals .....	5
Operating safety.....	5
Operating the Flatbed .....	6
Operating Controls .....	7
Trouble shooting.....	8-9
Maintenance.....	10

### SCHEMATICS AND PARTS LISTS

Bed assembly .....	12-13
Wiring harness and lights, std. bed.....	14-15
Wiring harness and lights, XRM bed .....	16-17
Valve assembly, small FPS .....	18
Valve assembly, large FPS .....	19
Electric schematic and hand control, 2-bank valve .....	20
Electric schematic and hand control, 3-bank valve .....	21
Hydraulic assembly, 2-bank valve .....	22
Hydraulic assembly, XRM.....	23
E/H power unit, hydraulic.....	24
E/H power unit, electric.....	25
Decal location .....	26
Spinners, risers, lift bar, four-foot bale adapter .....	27
Electric schematic, remote control .....	28
Valve assembly, Sterling 3-Bank.....	29

## DEWEZE MANUFACTURING

### STATEMENT OF WARRANTY

DewEze Manufacturing warrants to each purchaser of new DewEze Bale Pickup Flatbeds from an authorized dealer or representative that such equipment to be free from manufacturing defects which appear while in normal service for a period of TWO YEARS commencing with delivery to the original user (effective on Flatbeds sold after January 1, 1997).

The obligation of DewEze under this warranty is expressly limited, at our option, to replacement or repair at a service facility designated by DewEze or at the manufacturing plant in Harper, Kansas, of such part or parts as inspection shall disclose to have been defective. This warranty does not apply to defects caused by damage or unreasonable use (including failure to provide reasonable and necessary maintenance) while in the possession of the consumer.

DewEze shall not be liable for consequential damages of any kind, including but not limited to, consequential labor costs or transportation charges in connection with replacement or repair of defective parts.

DewEze makes no warranty with respect to trade accessories. They are subject to the warranties of their respective manufacturers.

ANY IMPLIED OR STATUTORY WARRANTIES, INCLUDING ANY WARRANTY OF MERCHANTABILITY OR FITNESS FOR A PARTICULAR PURPOSE, ARE EXPRESSLY LIMITED TO THE DURATION OF THIS WRITTEN WARRANTY. DewEze makes no other express warranty, nor is anyone authorized to make any on behalf of DewEze.

For information procedures please contact your nearest dealer.

## MODEL IDENTIFICATION

MODEL	372	375	378	380	382	385	387
WIDTH	7'	7'	7' 8"	7' 8"	7' 8"	7' 8"	7' 8"
LENGTH	9' 2"	8' 6"	8' 6"	9' 2"	9' 6"	10' 6"	11'
WEIGHT	1850	1800	1850	1900	1975	2135	2170

## FLATBED SPECIFICATIONS

HYDRAULIC SYSTEM	Powered by engine-driven pump or self-contained battery powered electric/hydraulic unit
SYSTEM PRESSURE	2450 psi
OIL RESERVOIR CAPACITY	10 Gal.
OIL FILTER	DewEze 720043, Wix 51551 (10 Micron)
CYLINDER, LIFT	4.50 x 16.64
CYLINDER, SQUEEZE	2.00 x 34.00 Double end
CYLINDER, EXTEND*	2.00 x 20.00
CYLINDER, EXTEND*	2.50 x 20.00

## BOLT TORQUE SPECIFICATIONS (EXCEPT AS SPECIFIED ELSEWHERE)

BOLT DIAMETER	BOLT TORQUE (ft-lb)
5/16"	19
3/8"	33
5/8"	160
1"	630

\* On XRM bed only.

## **SAFETY**

**TAKE NOTE! THIS SAFETY ALERT SYMBOL FOUND THROUGHOUT THIS MANUAL IS USED TO CALL YOUR ATTENTION TO INSTRUCTIONS INVOLVING YOUR PERSONAL SAFETY AND THE SAFETY OF OTHERS. FAILURE TO FOLLOW THESE INSTRUCTIONS CAN RESULT IN INJURY OR DEATH**



**THIS SYMBOL MEANS**

**- ATTENTION!**

**- BECOME ALERT!**

**- YOUR SAFETY IS INVOLVED!**

### **SIGNAL WORDS:**

Note the use of the signal words **DANGER**, **WARNING** and **CAUTION** with the safety messages. The appropriate signal word for each has been selected using the following guidelines:

**WARNING:** Indicates a potentially hazardous situation that, if not avoided, could result in death or serious injury, and includes hazards that are exposed when guards are removed. It may also be used to alert against unsafe practices.

**DANGER:** Indicates an imminently hazardous situation that, if not avoided, will result in death or serious injury. This signal word is to be limited to the most extreme situations typically for machine components which, for functional purposes, cannot be guarded.

**CAUTION:** Indicates a potentially hazardous situation that, if not avoided, may result in minor or moderate injury. It may also be used to alert against unsafe practices.

If you have questions not answered in this manual or require additional copies of the manual is damaged, please contact your dealer or DewEze Manufacturing, 151 E. Hwy 160, Harper, Kansas, 67058. (316)-896-7381, FAX (316)-896-7129.

200162

## SAFETY...YOU CAN LIVE WITH IT

### EQUIPMENT SAFETY GUIDELINES

Safety of the operator is one of the main concerns in designing and developing a new piece of equipment. Designers and manufacturers build in as many safety features as possible. However, every year many accidents occur which could have been avoided by a few seconds of thought and a more careful approach to handling equipment. You, the operator, can avoid many accidents by observing the following precautions in this section. To avoid personal injury, study the following precautions and insist those working with you, or for you, follow them.

In order to provide a better view, certain illustrations in this manual may show an assembly with a safety shield removed. However, equipment should never be operated in this condition. Keep all shields in place. If shield removal becomes necessary for repairs, replace the shield prior to use.

Do not attempt to operate this equipment under the influence of drugs or alcohol.

Review the safety instructions with all users annually.

This equipment is dangerous to children and persons unfamiliar with its operation. The operator should be a responsible adult familiar with farm machinery and trained in this equipment's operation. Do not allow persons to operate or assemble this unit until they have read this manual and have developed a thorough understanding of the safety precautions and of how it works.

### SAFETY SIGNS AND DECALS

Replace any CAUTION, WARNING, DANGER or instruction safety decal that is not readable or is missing. New decals are available from your authorized dealer or the DewEze factory. Location of such decals is indicated in this booklet. Do not paint over, remove or deface any safety signs or warning decals on your equipment. Observe all safety signs and practice the instructions on them.

### HOW TO INSTALL SAFETY SIGNS

- \* Be sure that the installation area is clean and dry.
- \* Decide on the exact position before you remove the backing paper.
- \* Remove the smallest portion of the split backing paper.
- \* Align the decal over the specified area and carefully press the small portion with the exposed sticky backing in place.
- \* Slowly peel back the remaining paper and carefully smooth the remaining portion of the decal in place.
- \* Small air pockets can be pierced with a pin and smoothed out using the piece of decal backing paper.

### GENERAL FLATBED SAFETY



**\* WARNING: Do not stand under the hugger arms when operating the bale pickup unit, even when the arms are empty.**

- \* Make sure all safety pins are in place and Flatbed mounting bolts are secure to the truck frame.
- \* Make sure hinges, joints, and sliding parts are well greased, especially during off season to prevent rusting and binding.
- \* Check with your truck dealer for any load limits, additional suspension or tire requirements. The Flatbed's lifting capability may exceed the truck's load capacity in a few instances.

### FLATBED HYDRAULIC SAFETY

- \* Do not activate the electric clutch unless the truck engine is at idle. Switching the clutch on at road speeds can seriously damage your hydraulic system.



**\* CAUTION: Do not operate the hydraulic system with the hood open.**

## BEFORE OPERATING

### FILL RESERVOIR

Park truck on level surface to check and fill reservoir. Fill reservoir until oil is between bottom and top sightglass. Reservoir holds approximately 10 gallons of oil.

**IN COLD WEATHER** (below 10° F) fill with hydraulic oil specifically rated for cold weather. Do not attach other hydraulic equipment to the Flatbed. The oil will intermix and the cold weather viscosity will be lost.

### FILL SYSTEM

Start engine and run both cylinders in and out or up and down twice to fill system with oil. Make sure the two hoses coming through the Flatbed frame to the squeeze arms do not kink or stretch during operation. Check for hydraulic leaks.

### SYSTEM PRESSURE

Connect a hydraulic test gauge to the quick couplers in hoses going to squeeze cylinder. Check hydraulic system for pressure. It should be 2450 psi.

## OPERATING INSTRUCTIONS

### STARTING

Turn pump ON with engine idling. (Red light will indicate pump is on.)

**IMPORTANT:** In cold weather, allow engine to idle for 5 to 10 minutes with pump on before operating the arms. This allows the oil to warm up and flow more freely. Neglecting this may cause hydraulic pump failure.

### LOADING

Back the truck against the bale with the arms wide apart and tilted slightly upward. Close the arms firmly against the bale. Lift the bale onto the truck. Release the bale and repeat the operation for the second bale. Lift the second bale onto the bed using it to push the first bale all the way forward. Do not release the second bale. When hauling one bale make sure it is resting on the bed. When hauling two bales make sure the second bale is as far forward as it will go (Fig. 1). Carrying a bale behind the bed as shown in Fig. 2 places excessive stress on the cylinder, linkage, and pins.

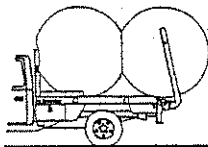

Fig. 1

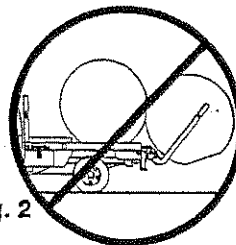

Fig. 2

### UNLOADING

Do the reverse of the loading operation.

**NOTE:** Sometimes it may be necessary to operate with spinners to grip the front bale for unloading.

### UNROLLING

With the arms laying on the bed, place the optional risers in the "eye" of the arms, and the spinners in the "eye" of the risers. Position the arms over the bale so the spinner is at the center of the bale. Close the arms and pick up the bale. To unroll, lower the bale onto the ground. Turn the pump off and stroke the Unload switch as you drive to gradually lower the arms as the bale unrolls.

**NOTE:** Without the risers, the spinners will not lower close enough to the ground to completely unroll the bale.

### STORING THE ARMS

Close the arms partially and lay on the flatbed. Open arms until they are flush with the side of the bed. They now serve as sides for the flatbed.

**TURN CLUTCH OFF** when not using hydraulic system. Operating the truck at road speeds, or above 2,000 RPM, with pump engaged, may cause hydraulic pump failure.



# OPERATING CONTROLS

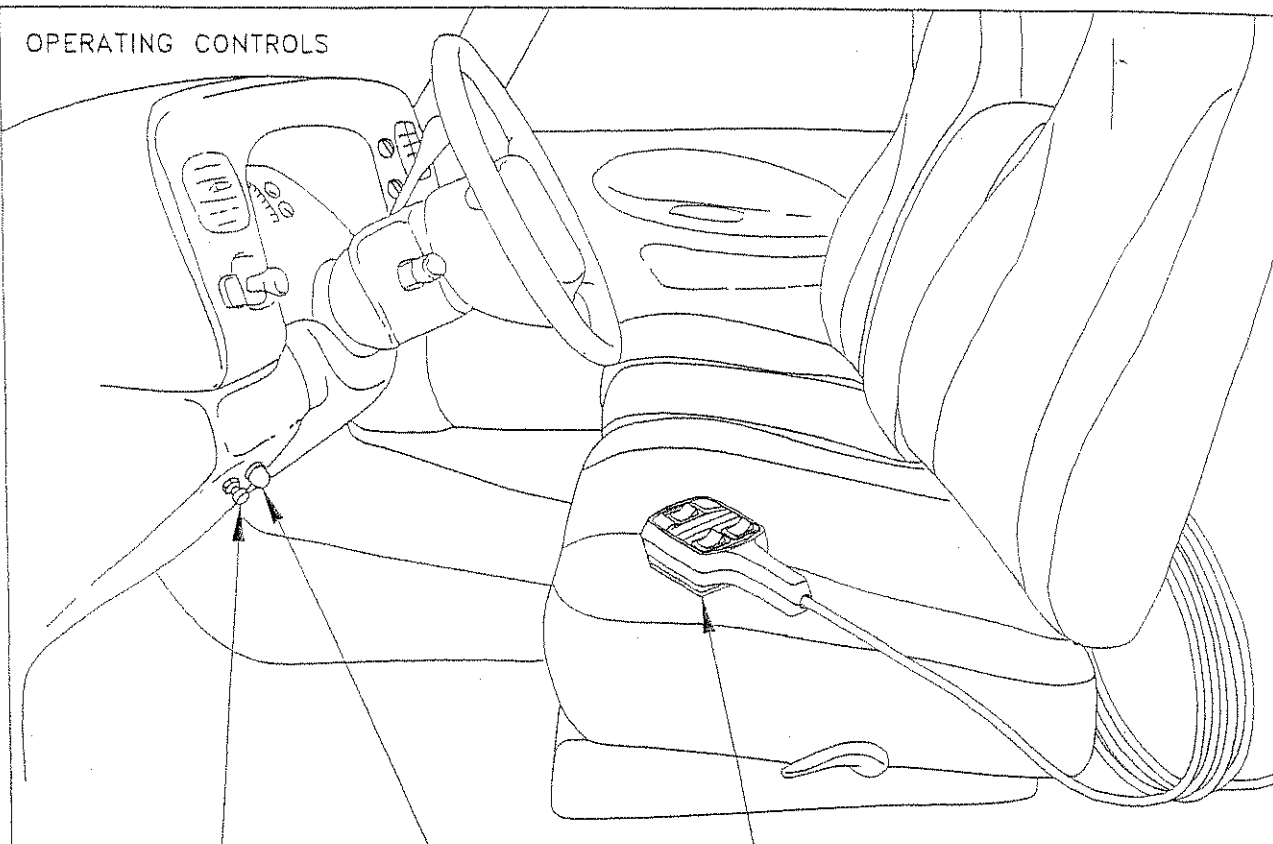

\*CLUTCH  
ON-OFF SWITCH

\*CLUTCH  
INDICATOR LAMP

HAND CONTROL

\*USED ONLY WITH 3-BANK VALVE OR CORDLESS REMOTE

3-BANK AND XRM  
HAND CONTROL

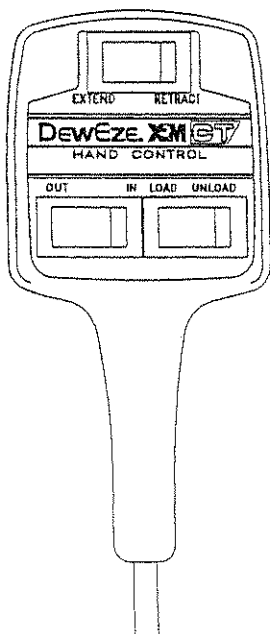

2-BANK  
HAND CONTROL

CLUTCH  
INDICATOR LAMP  
BUILT IN  
TO SWITCH

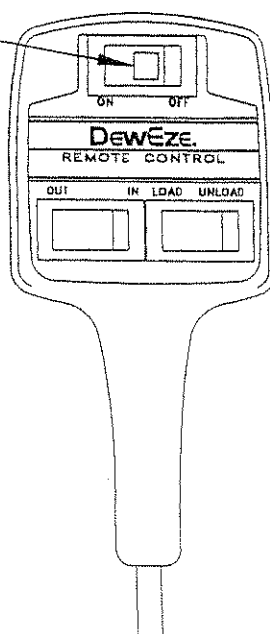

200164

## TROUBLE SHOOTING

PROBLEM AREA	SYMPTOM	POSSIBLE SOLUTIONS
Hydraulic Pump	No Oil Flow	<ol style="list-style-type: none"> <li>1. CHECK OIL LEVEL IN RESERVOIR. If oil level is low, check for leaks in system.</li> <li>2. CHECK BELT TENSION. Tighten if needed. Replace belt if necessary.</li> <li>3. CHECK FOR SHEARED KEY ON PUMP SHAFT. Replace key.</li> <li>4. CLUTCH NOT FUNCTIONING. See clutch section.</li> <li>5. INTERNAL PUMP DAMAGE. Have pump repaired or replaced.</li> <li>6. CHECK PRESSURE LINE AT PUMP TO SEE IF OIL IS MOVING.</li> </ol>
	No Oil Pressure	<ol style="list-style-type: none"> <li>1. VALVE NOT FUNCTIONING. Check for disconnected wires at solenoid.</li> <li>2. CHECK FOR POSSIBLE LEAKS IN SYSTEM. Repair leaks or blown hoses.</li> <li>3. CHECK FOR MALFUNCTIONING SWITCH. Replace broken switches.</li> <li>4. PRESSURE RELIEF SPRING BROKEN ALLOWING OIL TO BYPASS SYSTEM. Replace spring.</li> <li>5. PRESSURE SEAL ON PUMP IS BROKEN OR WORN. Replace.</li> <li>6. BELTS OR CLUTCH ARE SLIPPING. Tighten belts.</li> <li>7. PRESSURE RELIEF MAY BE SET TOO LOW. CAUTION: PRESSURE EXCEEDING 2,600 PSI CAN DAMAGE THE PUMP.</li> </ol>
Clutch	Does Not Engage	<ol style="list-style-type: none"> <li>1. CHECK FOR BLOWN FUSE. Replace. CAUTION: Fuse should not exceed 30 amps.</li> <li>2. CHECK WIRE TO CLUTCH. Insure there are no breaks or shorts in wire and that it is plugged into clutch lead.</li> <li>3. CHECK FOR BAD SWITCH IN SYSTEM. Replace.</li> <li>4. CHECK FOR BLOWN MAGNETIC COIL. Use jumper from positive battery terminal to coil lead to check coil. Replace coil if necessary.</li> </ol>
Belt(s)	Jumping Off Pulleys	<ol style="list-style-type: none"> <li>1. BELTS TOO LOOSE. Tighten belts.</li> <li>2. CHECK FOR EXCESSIVE BELT WEAR. Replace worn belts.</li> <li>3. CHECK FOR LOOSE PUMP BRACKET. Tighten loose bolts. Replace broken bolts.</li> <li>4. CHECK ALIGNMENT OF CLUTCH AND CRANKSHAFT PULLEYS. Re-align pulleys.</li> <li>5. CHECK CRANKSHAFT PULLEY FOR LOOSE OR BROKEN BOLTS. Tighten loose bolts. Replace broken bolts.</li> <li>6. CHECK ALIGNMENT OF IDLER PULLEY (IF APPLICABLE) AND THE CONDITION OF IDLER PULLEY BEARINGS. Re-align idler pulley. Replace worn or broken bearings.</li> </ol>

## TROUBLE SHOOTING - Cont.

Assuming the coil and electrical system seem to be functioning, use a screwdriver and push in on the button at the end of the tube assembly. (Note: The solenoids rest on this tube.) This will usually operate the valve.



**CAUTION:** Make sure no one is on or around moving parts of the equipment that is hooked to the hydraulic system.

If spool is jammed, do not force it as this may scar the spool or valve body. Disassemble valve, clean, and reassemble. If spool is still tight, use a very fine emery cloth to smooth burrs or rough edges on spool.

**NOTE:** The relief valve is preset from the factory. Warranty is voided if the valve pressure is increased beyond the factory setting.

For additional trouble shooting information and help contact your dealer.

## MAINTENANCE

1. Oil reservoir must be kept full at all times. Maintain the oil between the two sightglasses.
2. In cold weather, engage clutch and let the hydraulic system circulate until system sounds normal.
3. Change oil filter (10 micron) after first forty hours of use and then every 250 hours or annually thereafter.
4. Keep belt tension tight. Loose belts may cause premature wear of belts and pulleys.
5. Watch hydraulic system for signs of leakage. Loss of hydraulic fluid may cause serious damage to major hydraulic components.



**WARNING:** Do not check for hydraulic leaks with your hands while the system is operating. Use a piece of cardboard or wood. Hydraulic fluid escaping under pressure can penetrate the skin.

6. When quick-couplers leak, the O-ring may need to be replaced.
7. Examine the oil. If milky in appearance it is probably saturated with air or water and should be replaced with fresh oil.
8. Unusual sounds in the hydraulic pump or anywhere in the system should be investigated by a fluid power mechanic.
9. High heat, 190° or greater, can be damaging to the hydraulic system. Feel various parts of the system to make sure there are no "hot spots" which may indicate a problem is developing.
10. Clutch should be disengaged when hydraulic system is not in use.
11. Make sure quick-disconnect couplers are clean, properly connected and mated, so that oil flows freely from hydraulic power source to implement.
12. For easy hookup of the couplers, shut clutch switch "off" and activate control valve switches with the ignition "on". This will release the pressure in the lines on the truck.
13. When quick-couplers are not in use, cover with dust caps.
14. Engine should not exceed 2,000 RPM with clutch engaged and pump operating.
15. Grease the locations once a week as indicated in the illustration below.

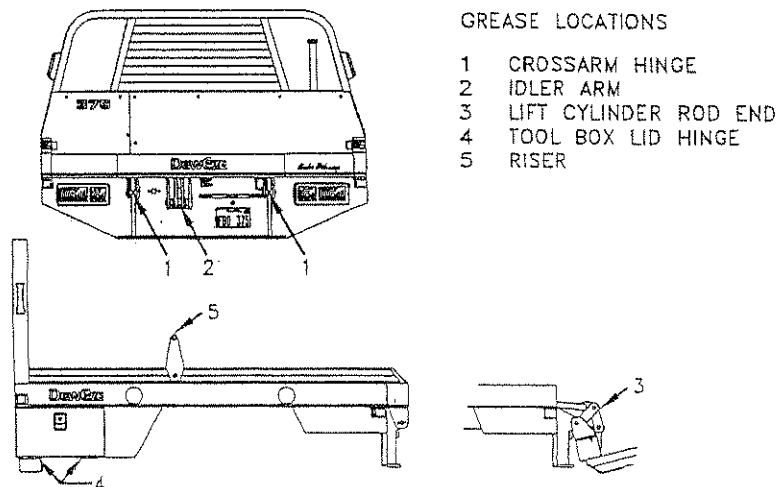

# Schematics & Parts Section

# BED ASSEMBLY

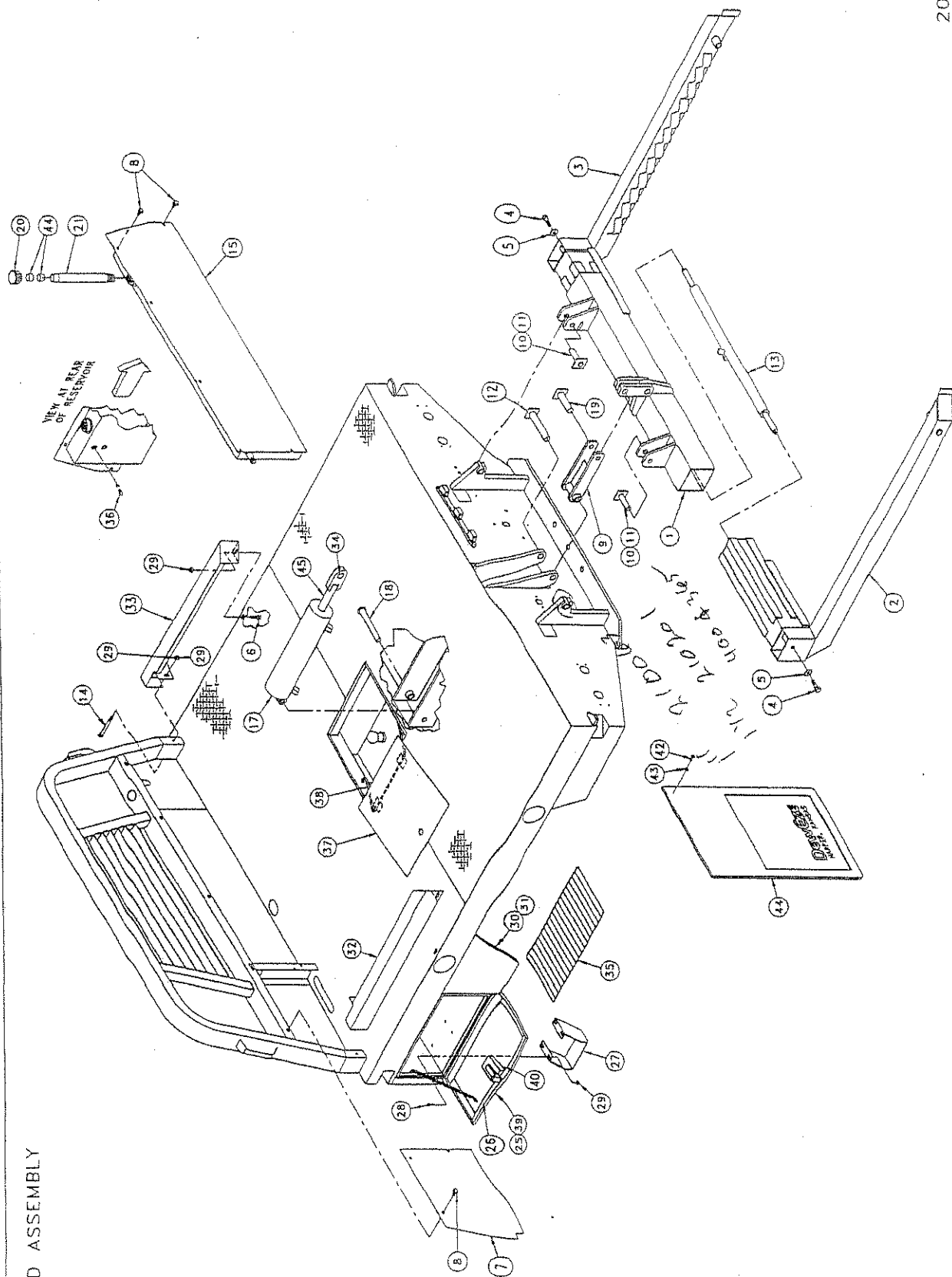

200152

# BED ASSEMBLY

ITEM	PART NO.	DESCRIPTION			
1	210744	CROSSARM ASSY	30	210170	FENDER/L 375,378,380,382
2	210737	HUGGER ARM/L		210283	FENDER/L 385,387
3	210738	HUGGER ARM/R	31	210171	FENDER/R 375,378,380,382
4	210128	5/8NC X 1 1/2 BOLT		210284	FENDER/R 385,387
5	310344	5/8 FLAT WASHER	32	210663	SIDE RAIL/L 375
6	510063	3/8NC X 1 BOLT		210667	SIDE RAIL/L 378
7	210640	VALVE COVER PLATE		210671	SIDE RAIL/L 380
8	511082	3/8NC X 1 1/2 WIZ BOLT		210675	SIDE RAIL/L 382
9	210935	IDLER ARM		210679	SIDE RAIL/L 385
10	100465	1/8 X 1 1/4 COTTER PIN		210683	SIDE RAIL/L 387
11	210757	PIN/CROSSARM 1.00 X 3.25	33	210661	SIDE RAIL/R 375
12	210755	PIN/IDLER 1.25 X 6.75		210665	SIDE RAIL/R 378
13	220002	SQUEEZE CYLINDER		210669	SIDE RAIL/R 380
14	710510	3/8NC X 5 BOLT		210673	SIDE RAIL/R 382
15	220495	RESERVOIR		210677	SIDE RAIL/R 385
16	510174	GREASE ZERK		210681	SIDE RAIL/R 387
17	220452	CYLINDER/LIFT	34	200129	BUSHING/LIFT CYL. LUG
18	210112	PIN/BASE 1.00 X 8.00	35	200118	MAT/TOOL BOX
19	210753	PIN/ROD 1.25 X 4.02	36	200116	BULB AND O-RING/SIGHTGLASS
20	220382	FILLER CAP	37	210919	LID/RECESSED WELL
21	220403	FILLER NECK	38	210892	HINGE ROD/RECESSED WELL LID
22	510365	3/8 FLAT WASHER	39	200100	HINGE/TOOL BOX LID
23	510271	3/8 LOCK WASHER	40	210100	LATCH/TOOL BOX LID
24	510272	3/8NC NUT	41	710586	1/4 X 1 SELF TAPPING SCREW
25	210568	TOOL BOX	42	510322	1/4 FLAT WASHER
26	200126	SEAL/TOOL BOX LID	43	210174	MUD FLAP/WIDE BED
27	210697	STEP		210178	MUD FLAP/NARROW BED
28	510401	3/8NC X 3/4 WIZ BOLT	44	220515	SPLASH GUARD/FILLER NECK
29	710631	3/8NC WIZ NUT	45	220552	CYLINDER ROD WELD ASSY w/LUG

- 14 -



# WIRING HARNESS/LIGHTS VIEW INSIDE REAR PLATE

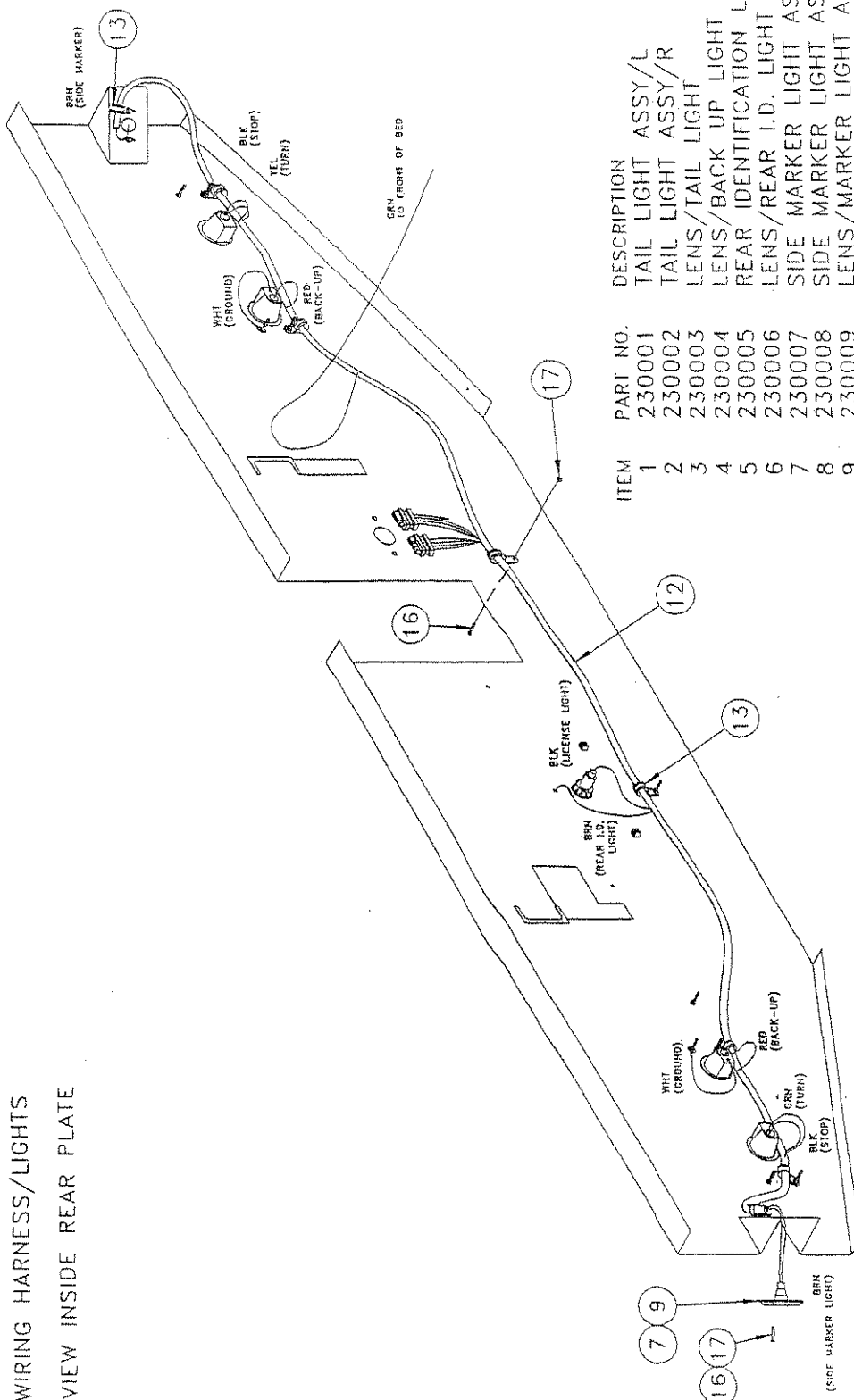

ITEM	PART NO.	DESCRIPTION
1	230001	TAIL LIGHT ASSY/L
2	230002	TAIL LIGHT ASSY/R
3	230003	LENS/TAIL LIGHT
4	230004	LENS/BACK UP LIGHT
5	230005	REAR IDENTIFICATION LIGHT
6	230006	LENS/REAR I.D. LIGHT
7	230007	SIDE MARKER LIGHT ASSY/AMBER
8	230008	SIDE MARKER LIGHT ASSY/RED
9	230009	LENS/MARKER LIGHT AMBER
10	230010	LENS/MARKER LIGHT RED
11	230011	LICENSE LIGHT
12	230072	WIRING HARNESS
13	200019	ADEL CLAMP AC-10
14	130011	ADEL CLAMP AC-6
15	200066	WIRE CLIP
16	510094	10-24 X 1 SCREW
17	210336	10-24 NUT
18	200051	NYLON LICENSE PLATE SCREW INSERT

# XRM WIRING HARNESS/LIGHTS

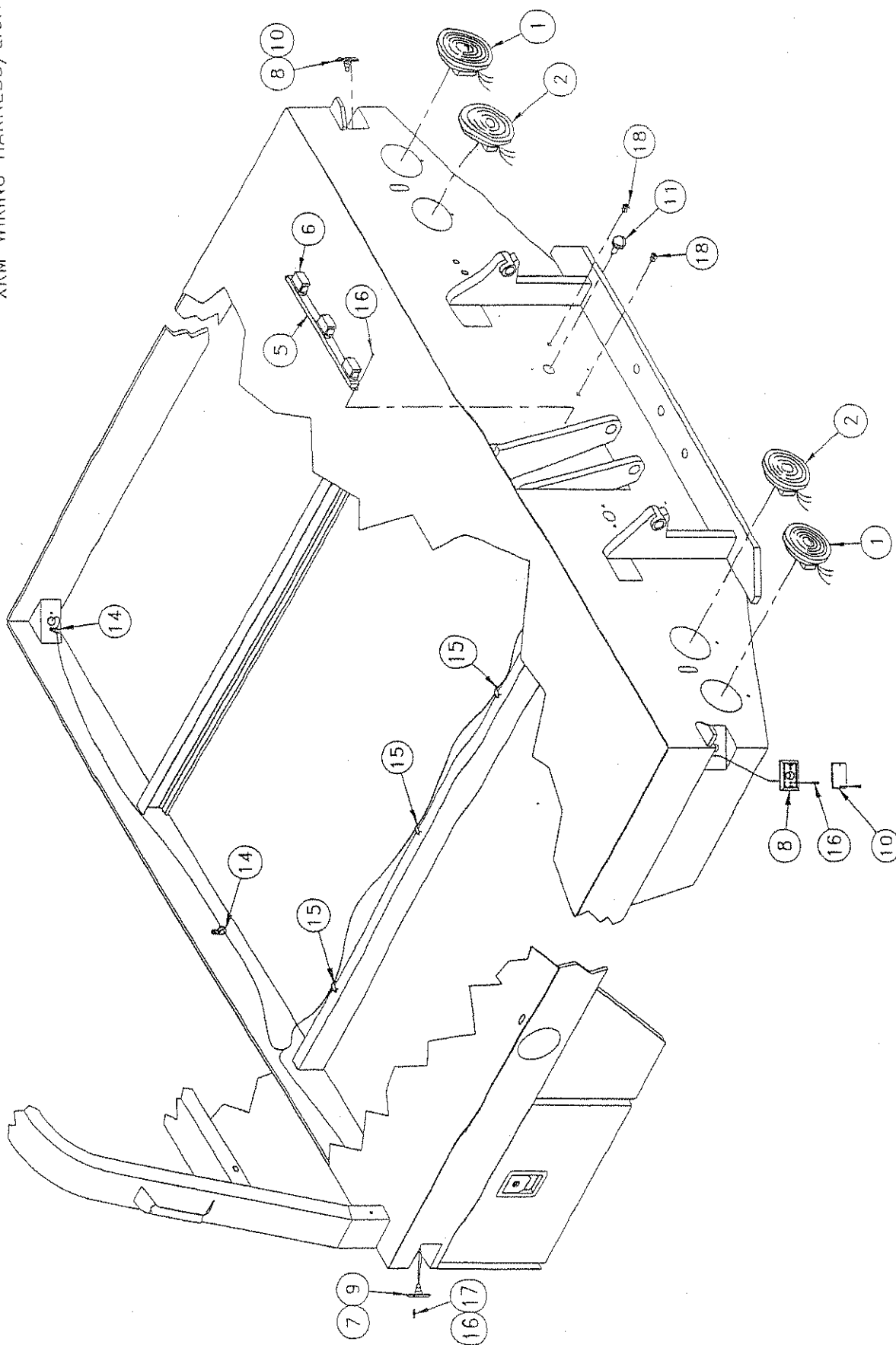

200161

# XRM WIRING HARNESS/LIGHTS VIEW INSIDE REAR PLATE

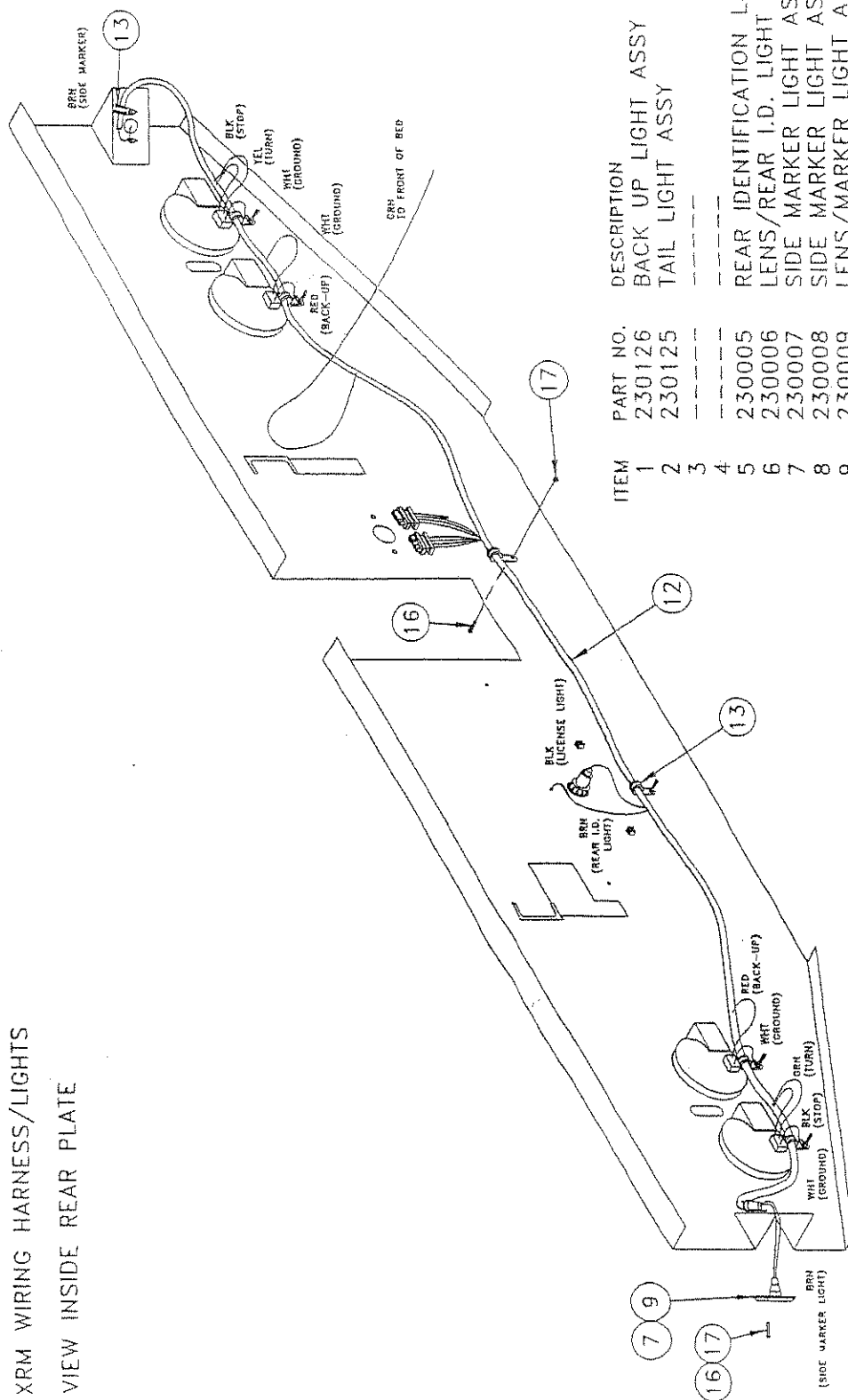

ITEM	PART NO.	DESCRIPTION
1	230126	BACK UP LIGHT ASSY
2	230125	TAIL LIGHT ASSY
3	---	---
4	---	---
5	230005	REAR IDENTIFICATION LIGHT
6	230006	LENS/REAR I.D. LIGHT
7	230007	SIDE MARKER LIGHT ASSY/AMBER
8	230008	SIDE MARKER LIGHT ASSY/RED
9	230009	LENS/MARKER LIGHT AMBER
10	230010	LENS/MARKER LIGHT RED
11	230011	LICENSE LIGHT
12	230072	WIRING HARNESS
13	200019	ADEL CLAMP AC-10
14	130011	ADEL CLAMP AC-6
15	200066	WIRE CLIP
16	510094	10-24 X 1 SCREW
17	210336	10-24 NUT
18	200051	NYLON LICENSE PLATE SCREW INSERT

# VALVE ASSEMBLY\FPS SMALL

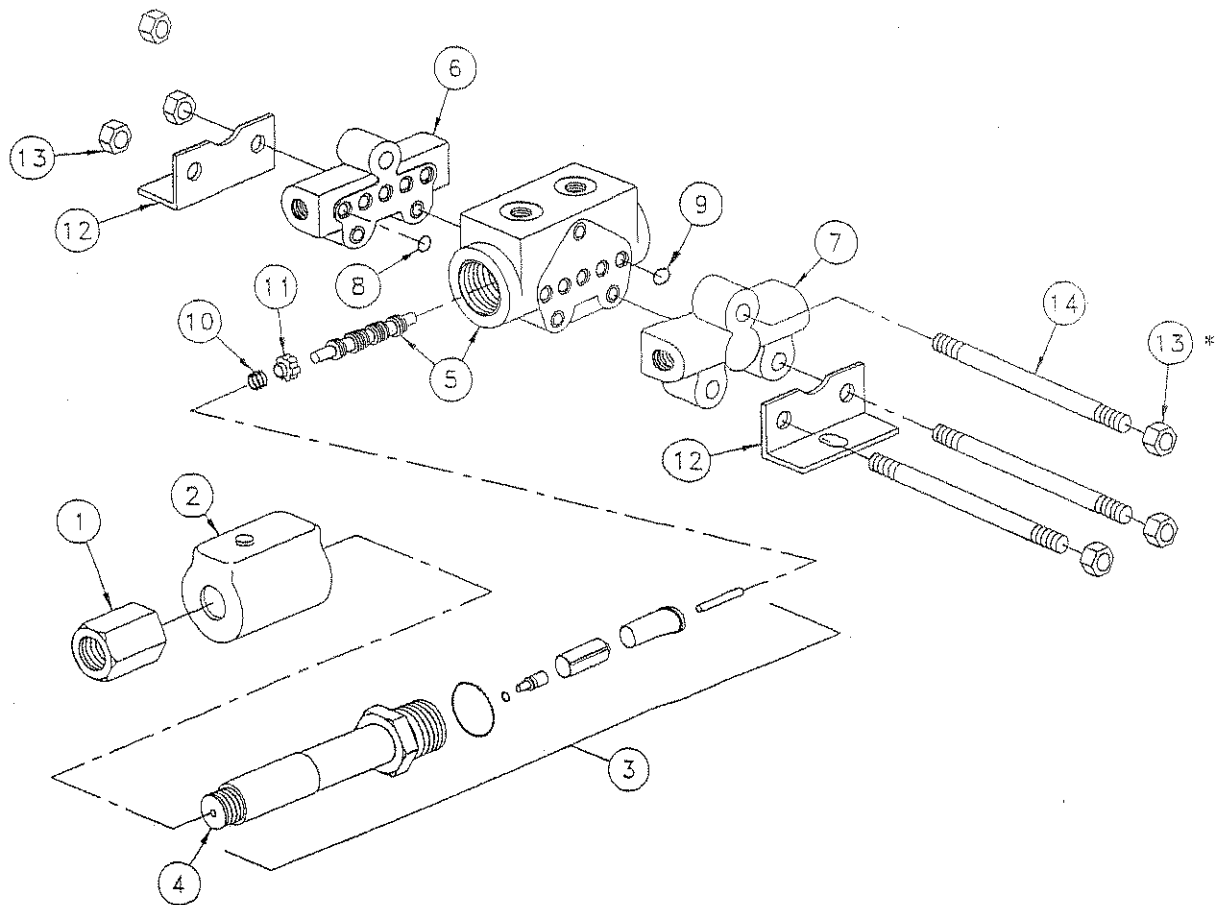

ITEM	PART NO.	DESCRIPTION
1	720005	Nut
2	720004	Solenoid coil
3	720003	Tube sub-assembly
4	720017	Tube
5	720002	Body and spool
6	720008	Outlet
7	720006	Inlet
8	720019	O-ring/outlet
9	720018	O-ring/inlet
10	720023	Spring
11	720024	Spring retainer
12	720022	Mounting bracket
13*	510208	5/16-18 Nut
14	220048	Tie rod/1 bank
	220332	Tie rod/2 bank
	720128	Tie rod/3 bank

\* TORQUE TO 1.15 in-lb

200124

# VALVE ASSEMBLY\FPS LARGE

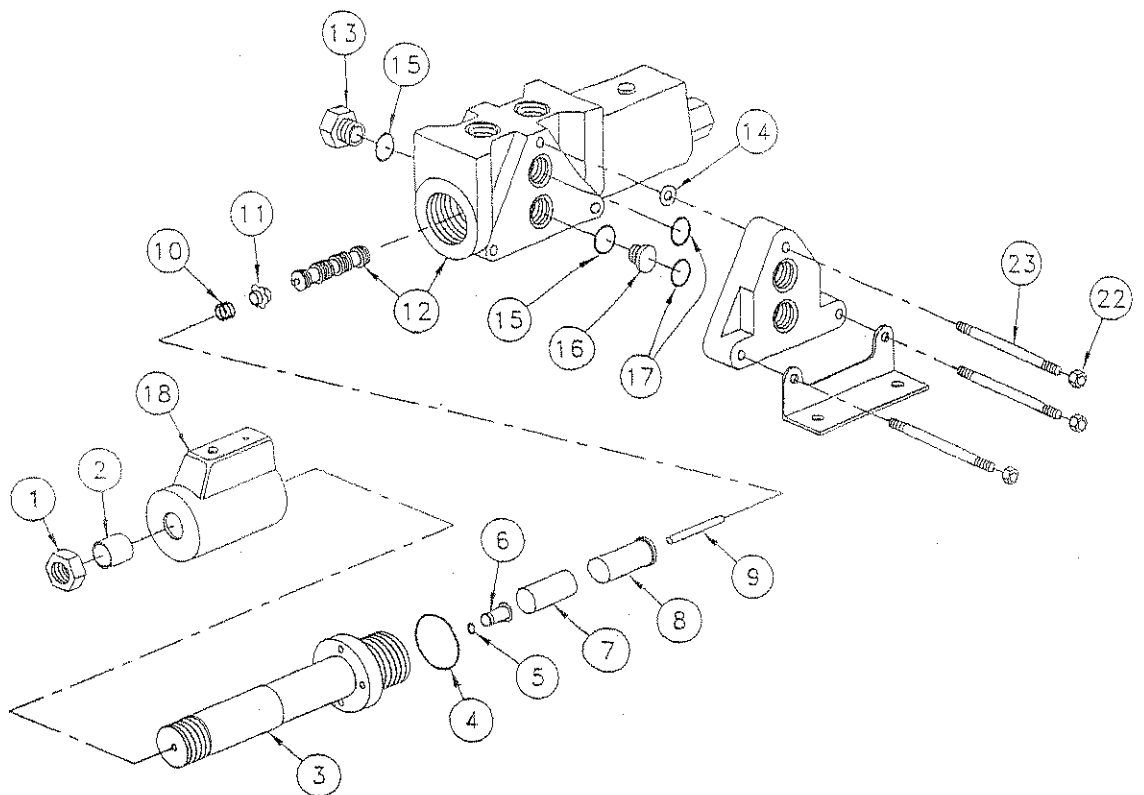

ITEM	PART NO.	DESCRIPTION
1	720044	Nut
2	720045	Sleeve
3	720046	Tube Sub-assembly
4	720047	O-ring
5	720048	O-ring
6	720050	Button
7	720051	Plunger
8	720052	Plug
9	720053	Pin
10	720054	Spring
11	720055	Retainer/spring
12	720056	Spool & body (matched set)
13	720057	Plug
14	720058	Mylar shim
15	720059	O-ring
16	720060	Series plug
17	720061	O-ring
18	720062	Solenoid coil
19	220047	Relief valve
20	220043	Valve assembly/1-bank
21	220044	Valve assembly/2 bank w/relief
22*	510208	5/16-18 Nut
23	220332	Tie rod/1 bank
	720128	Tie rod/2 bank
	220051	Tie rod/3 bank

\* TORQUE TO 115 in-lb

200124

# ELECTRIC SCHEMATIC/HAND CONTROL

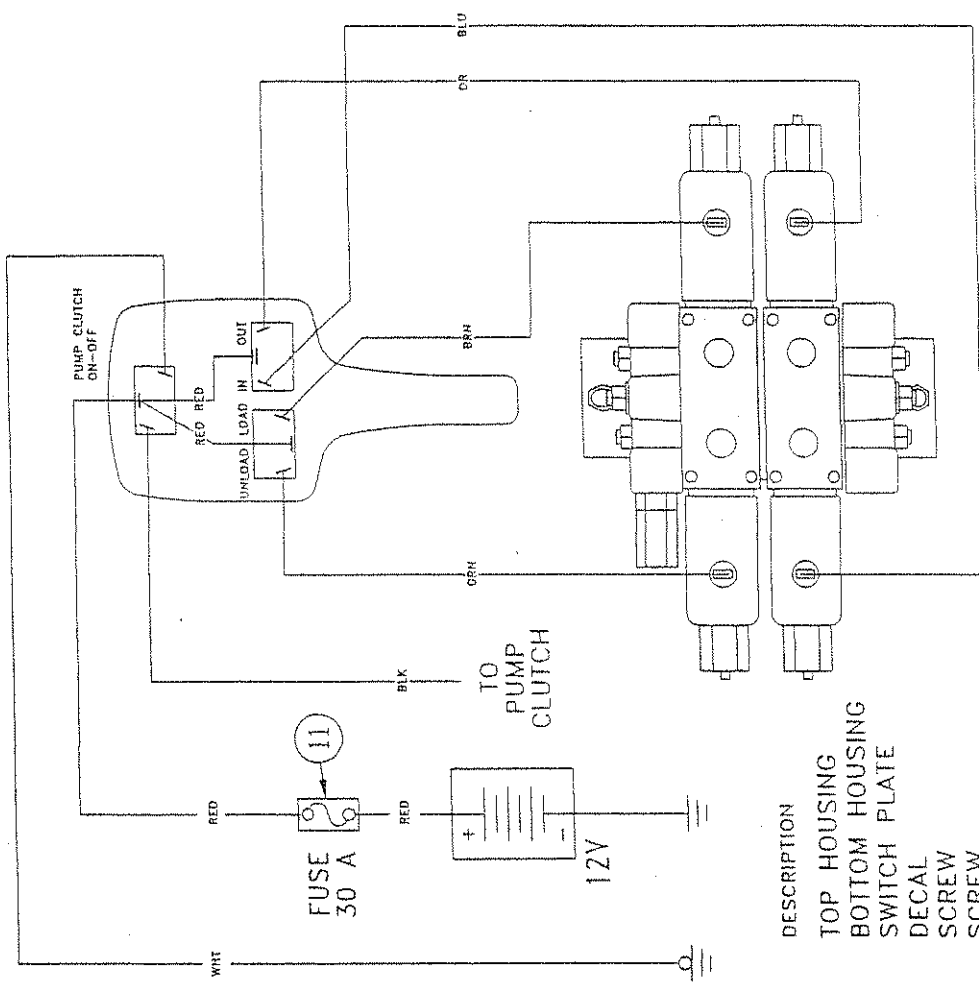
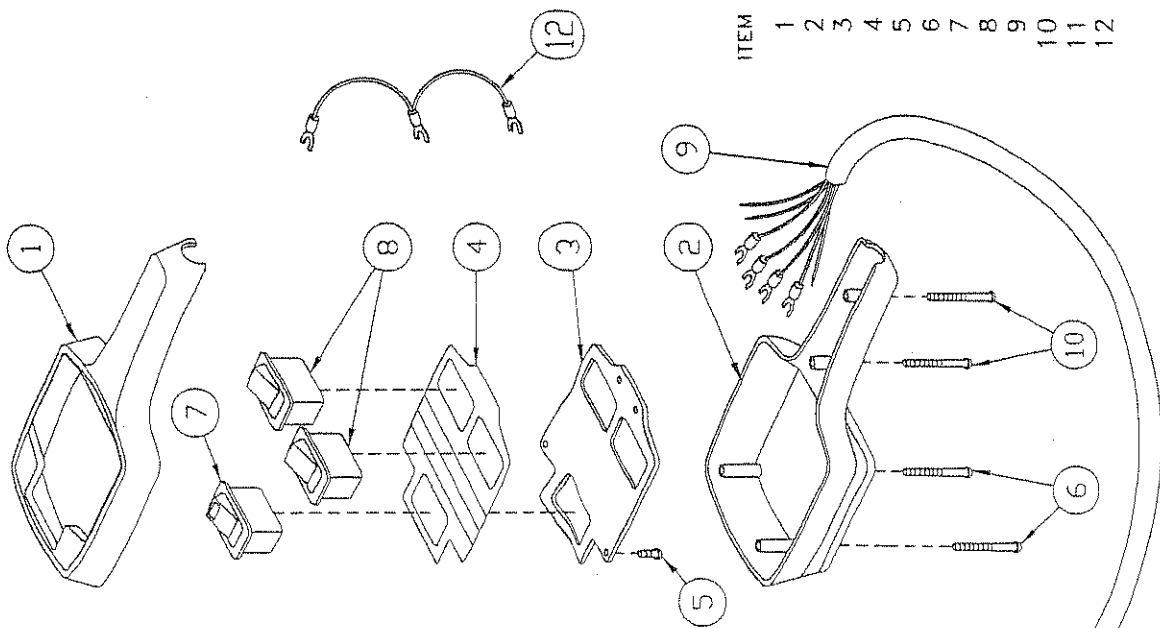

ITEM	PART NO.	DESCRIPTION
1	150001	TOP HOUSING
2	150003	BOTTOM HOUSING
3	150002	SWITCH PLATE
4	150004	DECAL
5	150013	SCREW
6	150015	SCREW
7	130001	LIGHTED SWITCH
8	130002	MOMENTARY SWITCH
9	230013	CABLE/7-WIRE
10	150014	SCREW
11	730007	FUSE HOLDER
12	130032	JUMPER WIRE
	150011	HAND CONTROL ASSY. (INC. 1-8,10,12)

200113

# ELECTRIC SCHEMATIC/HAND CONTROL 3 BANK VALVE

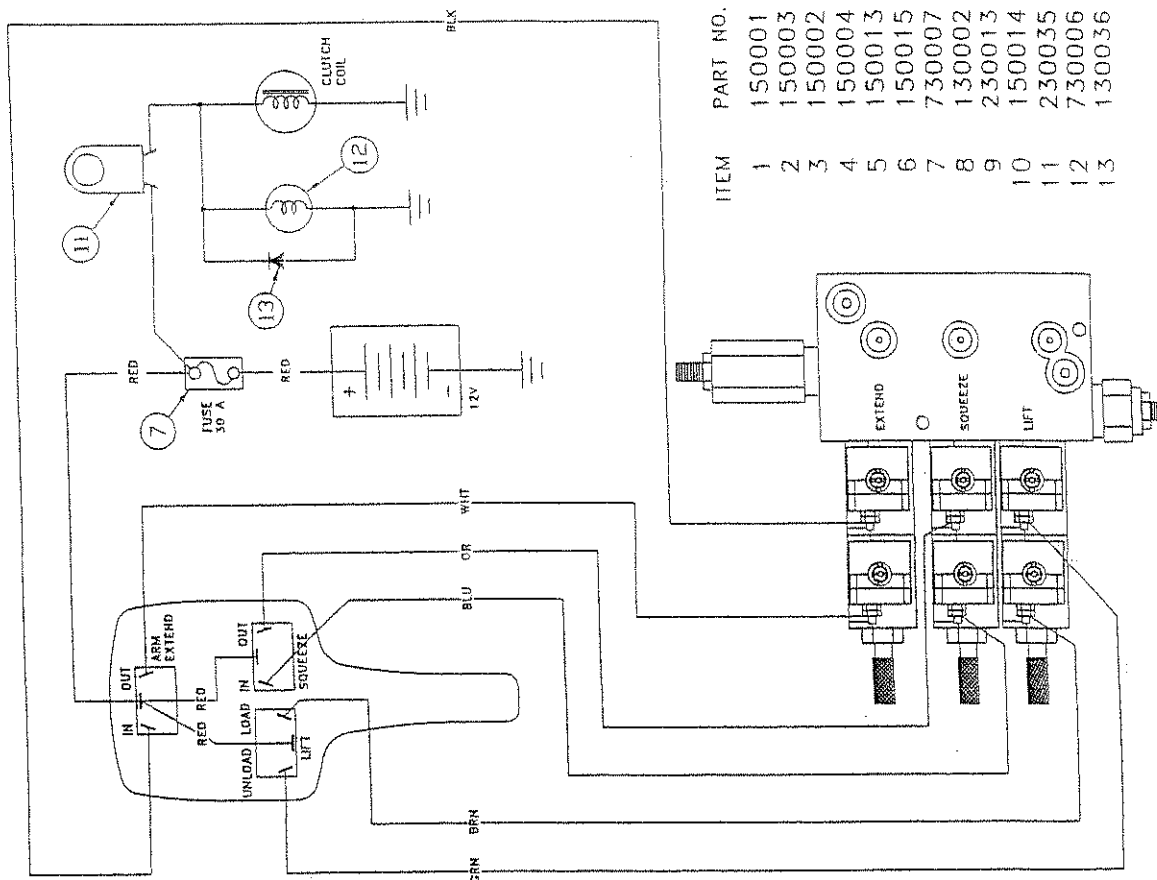
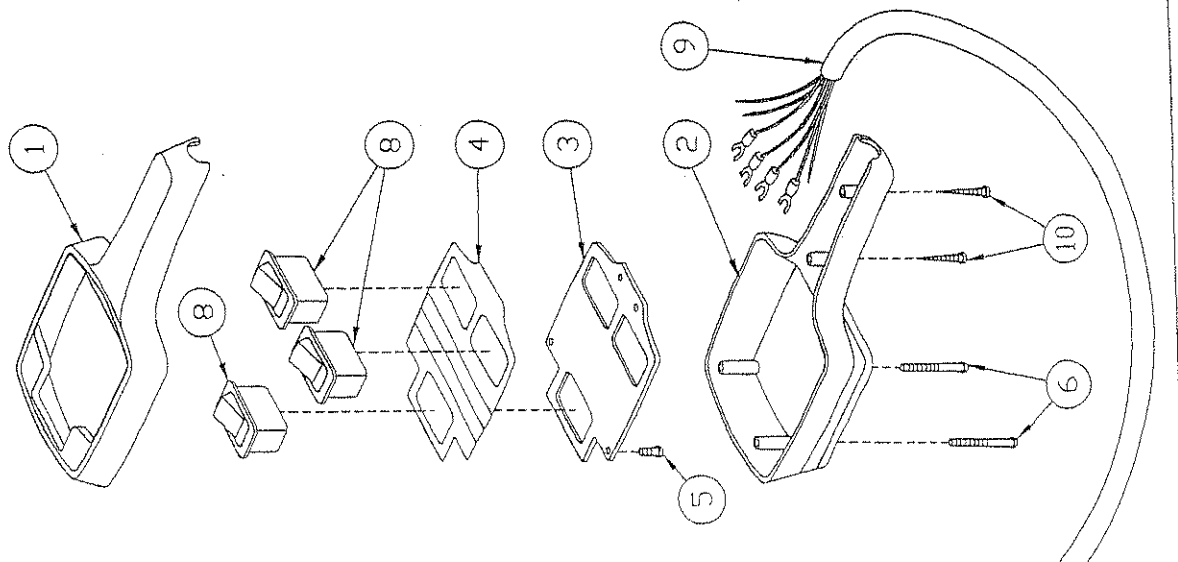

ITEM	PART NO.	DESCRIPTION
1	150001	TOP HOUSING
2	150003	BOTTOM HOUSING
3	150002	SWITCH PLATE
4	150004	DECAL
5	150013	SCREW
6	150015	SCREW
7	730007	FUSE HOLDER
8	130002	MOMENTARY SWITCH
9	230013	CABLE/7-WIRE
10	150014	SCREW
11	230035	CLUTCH SWITCH
12	730006	INDICATOR LAMP
13	130036	DIODE

200155

# HYDRAULIC ASSEMBLY 2-BANK VALVE

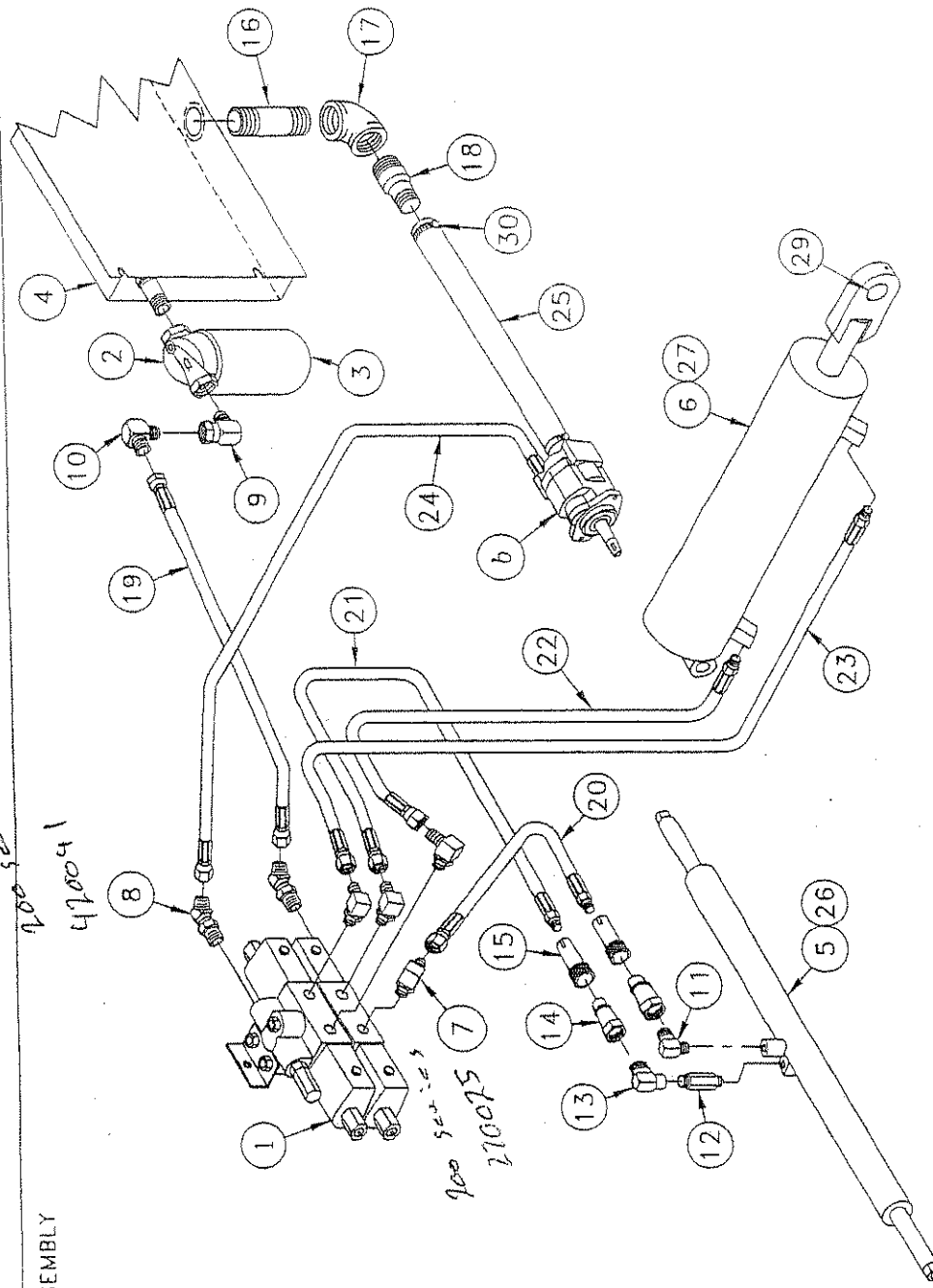

ITEM	PART NO.	DESCRIPTION	CONNECTOR	21.	22.	23.	24.	25.	26.	27.	28.	29.	30.
1.	220052	VALVE	90° ADAPTER	21.	22.	23.	24.	25.	26.	27.	28.	29.	30.
2.	720042	FILTER HEAD	QUICK COUPLER/MALE	21.	22.	23.	24.	25.	26.	27.	28.	29.	30.
3.	720043	FILTER (WIX 51551)	QUICK COUPLER/FEMALE	21.	22.	23.	24.	25.	26.	27.	28.	29.	30.
4.	220399	RESERVOIR	PIPE NIPPLE 1/4 X 10	21.	22.	23.	24.	25.	26.	27.	28.	29.	30.
5.	220002	SQUEEZE CYLINDER	PIPE ELL 1/4 12,17 GAL	21.	22.	23.	24.	25.	26.	27.	28.	29.	30.
6.	220452	LIFT CYLINDER 4.5"	PIPE ELL 1/4 -1" 7.9 GAL	21.	22.	23.	24.	25.	26.	27.	28.	29.	30.
7.	520026	90° ADAPTER	HOSE BARB 1/4 12,17 GAL	21.	22.	23.	24.	25.	26.	27.	28.	29.	30.
8.	120087	45° ADAPTER	HOSE BARB 1" 7.9 GAL	21.	22.	23.	24.	25.	26.	27.	28.	29.	30.
9.	220033	90° SWIVEL ADAPTER	HOSE/RESERVOIR RETURN	21.	22.	23.	24.	25.	26.	27.	28.	29.	30.
10.	420039	90° SWIVEL ADAPTER	HOSE/SQUEEZE CYL. BASE	21.	22.	23.	24.	25.	26.	27.	28.	29.	30.
11.	220005	90° ADAPTER	HOSE/SQUEEZE CYL. BASE	21.	22.	23.	24.	25.	26.	27.	28.	29.	30.
			CONNECTOR	21.	22.	23.	24.	25.	26.	27.	28.	29.	30.
			90° ADAPTER	21.	22.	23.	24.	25.	26.	27.	28.	29.	30.
			QUICK COUPLER/MALE	21.	22.	23.	24.	25.	26.	27.	28.	29.	30.
			QUICK COUPLER/FEMALE	21.	22.	23.	24.	25.	26.	27.	28.	29.	30.
			PIPE NIPPLE 1/4 X 10	21.	22.	23.	24.	25.	26.	27.	28.	29.	30.
			PIPE ELL 1/4 12,17 GAL	21.	22.	23.	24.	25.	26.	27.	28.	29.	30.
			PIPE ELL 1/4 -1" 7.9 GAL	21.	22.	23.	24.	25.	26.	27.	28.	29.	30.
			HOSE BARB 1/4 12,17 GAL	21.	22.	23.	24.	25.	26.	27.	28.	29.	30.
			HOSE BARB 1" 7.9 GAL	21.	22.	23.	24.	25.	26.	27.	28.	29.	30.
			HOSE/RESERVOIR RETURN	21.	22.	23.	24.	25.	26.	27.	28.	29.	30.
			HOSE/SQUEEZE CYL. BASE	21.	22.	23.	24.	25.	26.	27.	28.	29.	30.
			HOSE/SQUEEZE CYL. BASE	21.	22.	23.	24.	25.	26.	27.	28.	29.	30.
			HOSE/LIFT CYL. BASE	21.	22.	23.	24.	25.	26.	27.	28.	29.	30.
			HOSE/LIFT CYL. ROD	21.	22.	23.	24.	25.	26.	27.	28.	29.	30.
			HOSE/PUMP RETURN	21.	22.	23.	24.	25.	26.	27.	28.	29.	30.
			HOSE/SUCTION	21.	22.	23.	24.	25.	26.	27.	28.	29.	30.
			SEAL KIT/SQUEEZE CYL.	21.	22.	23.	24.	25.	26.	27.	28.	29.	30.
			SEAL KIT/LIFT CYL.	21.	22.	23.	24.	25.	26.	27.	28.	29.	30.
			O-RING/QUICK COUPLER	21.	22.	23.	24.	25.	26.	27.	28.	29.	30.
			BUSHING/SPLIT RING	21.	22.	23.	24.	25.	26.	27.	28.	29.	30.
			HOSE CLAMP #20 1.25"	21.	22.	23.	24.	25.	26.	27.	28.	29.	30.
			HOSE CLAMP #24 1.50"	21.	22.	23.	24.	25.	26.	27.	28.	29.	30.

200154

a PART NO's FOR HOSES DEPEND ON FLATBED MODEL NO. AND WHETHER TRUCK HAS A STANDARD OR EXTENDED CAB.

b PART NO's FOR PUMP AND FITTINGS DEPEND ON PUMP SIZE.



This technical diagram illustrates the exploded view of a hydraulic assembly, with components numbered 1 through 40. The assembly includes a central manifold (1) with multiple ports, a pump or motor unit (2) with a drive shaft (16) and a coupling (17). A large cylindrical component (3) is connected to the manifold via a hose (4). A long, thin cylinder (5) is connected to the manifold via a hose (6). A large cylindrical component (7) is connected to the manifold via a hose (8). A large cylindrical component (9) is connected to the manifold via a hose (10). A large cylindrical component (11) is connected to the manifold via a hose (12). A large cylindrical component (13) is connected to the manifold via a hose (14). A large cylindrical component (15) is connected to the manifold via a hose (16). A large cylindrical component (17) is connected to the manifold via a hose (18). A large cylindrical component (19) is connected to the manifold via a hose (20). A large cylindrical component (21) is connected to the manifold via a hose (22). A large cylindrical component (23) is connected to the manifold via a hose (24). A large cylindrical component (25) is connected to the manifold via a hose (26). A large cylindrical component (27) is connected to the manifold via a hose (28). A large cylindrical component (29) is connected to the manifold via a hose (30). A large cylindrical component (31) is connected to the manifold via a hose (32). A large cylindrical component (33) is connected to the manifold via a hose (34). A large cylindrical component (35) is connected to the manifold via a hose (36). A large cylindrical component (37) is connected to the manifold via a hose (38). A large cylindrical component (39) is connected to the manifold via a hose (40).

α	HOSE/SQUEEZE CYL. BASE
α	HOSE/SQUEEZE CYL. ROD
α	HOSE/PUMP RETURN
α	HOSE/SUCTION
α	HOSE/EXTENSION CYL. BASE
α	HOSE/EXTENSION CYL. ROD
2200601	HOSE/CROSSOVER
2200056	SEAL KIT/SQUEEZE CYL.
2200464	SEAL KIT/LIFT CYL.
2200503	SEAL KIT/EXT CYL. 2.00"
2200499	SEAL KIT/EXT CYL. 2.50"
4200050	O-RING/QUICK COUPLER
200129	BUSHING/SPLIT RING
220107	HOSE CLAMP #20 1.25"
511002	HOSE CLAMP #24 1.50"

200157

HYDRAULIC ASSY  
E/H POWER UNIT

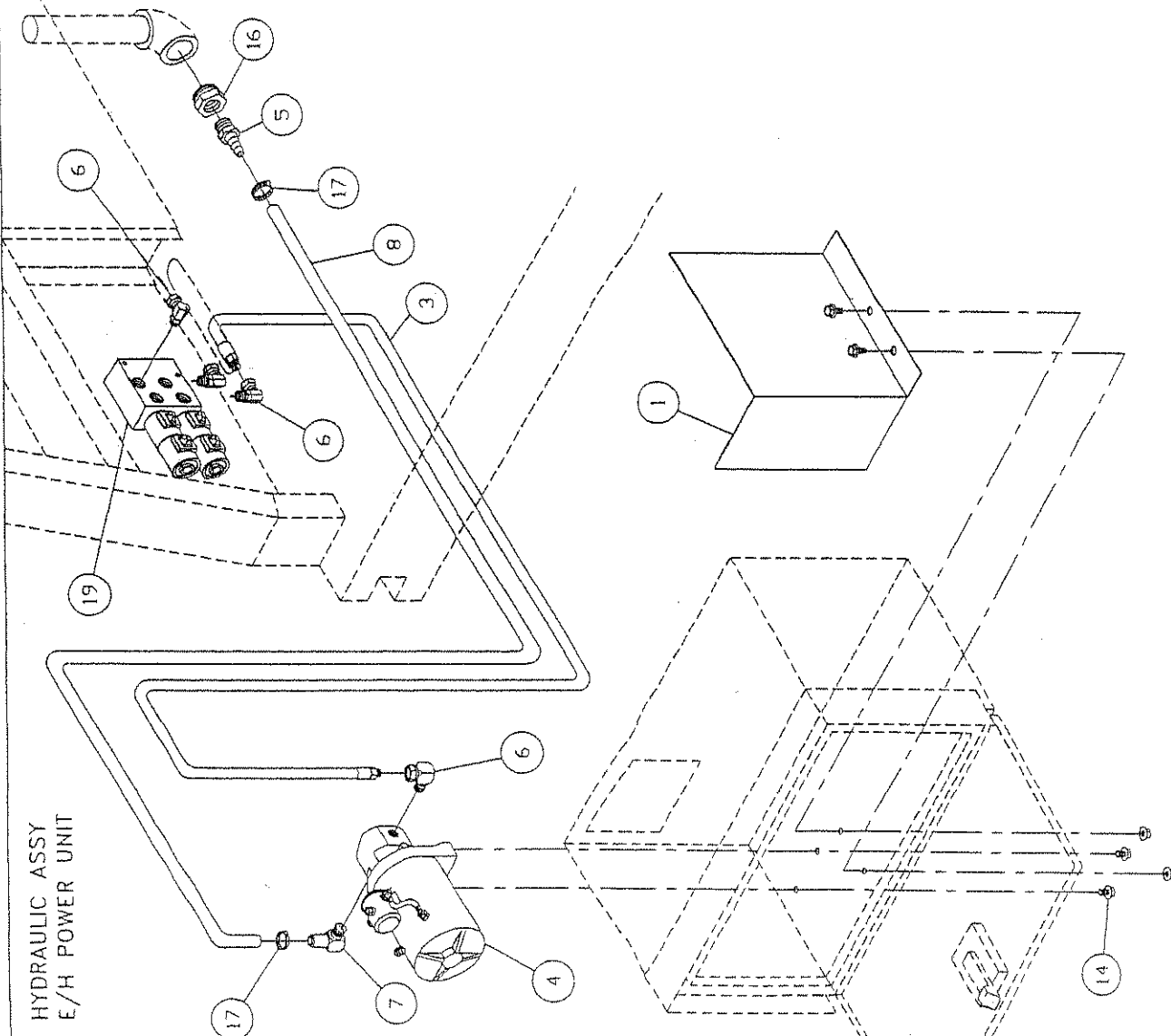

ITEM	PART NO.	DESCRIPTION
1	210889	E/H SHIELD
2	130006	CABLE/6-WIRE
3	150027	HAND CONTROL & CABLE ASSY
4	220508	3/8 HOSE
5	230140	E/H MOTOR - PUMP UNIT
6	210884	MOTOR
7	230045	SOLENOID
8	520033	ADAPTER
9	220025	ADAPTER
10	220553	ADAPTER ASSY.
11	220556	SUCTION HOSE
12	230116	BATTERY CABLE/MOTOR END
13	230124	BATTERY CABLE/BATTERY END
14	410216	5/16NC X 2 1/2 BOLT
15	510335	5/16 LOCK WASHER
16	510208	5/16NC NUT
17	510401	3/8NC X 3/4 WIZ FLG BOLT
18	510090	5/16NC X 1 BOLT
19	720071	3/4-1 1/4 PIPE BUSHING
20	520099	HOSE CLAMP
21	230119	CABLE/SOLENOID GROUND
22	220492	E/H VALVE
23	150001	TOP HOUSING
24	150003	BOTTOM HOUSING
25	150002	SWITCH PLATE
26	150004	DECAL
27	150013	SCREW
28	150015	SCREW
29	150014	SCREW
30	130029	SWITCH DPDT
31	130002	MOMENTARY SWITCH
32	150029	JUMPER WIRE/HOT (2 SPADE)
	150030	JUMPER WIRE/HOT (4 SPADE)
	150031	JUMPER WIRE/GRN. (2 SPADE)
	150032	JUMPER WIRE/BRN. (2 SPADE)

# WIRING ASSY E/H POWER UNIT

DETAIL INCLUDES: A-#210893, B-#230118  
WIRING AND HYDRAULIC PLUMBING FOR E/H  
FLATBEDS PRIOR TO SERIAL #FB99111.

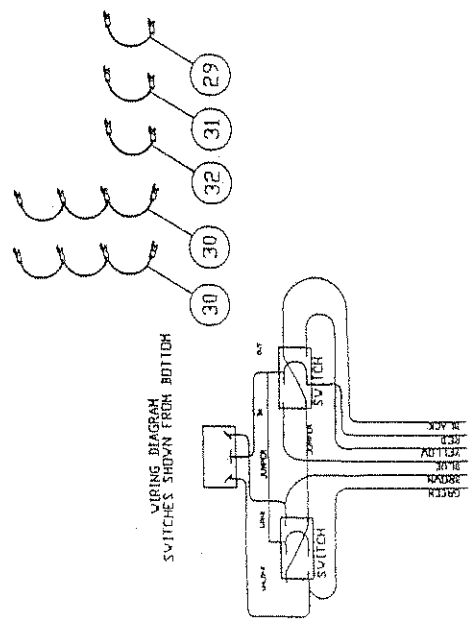
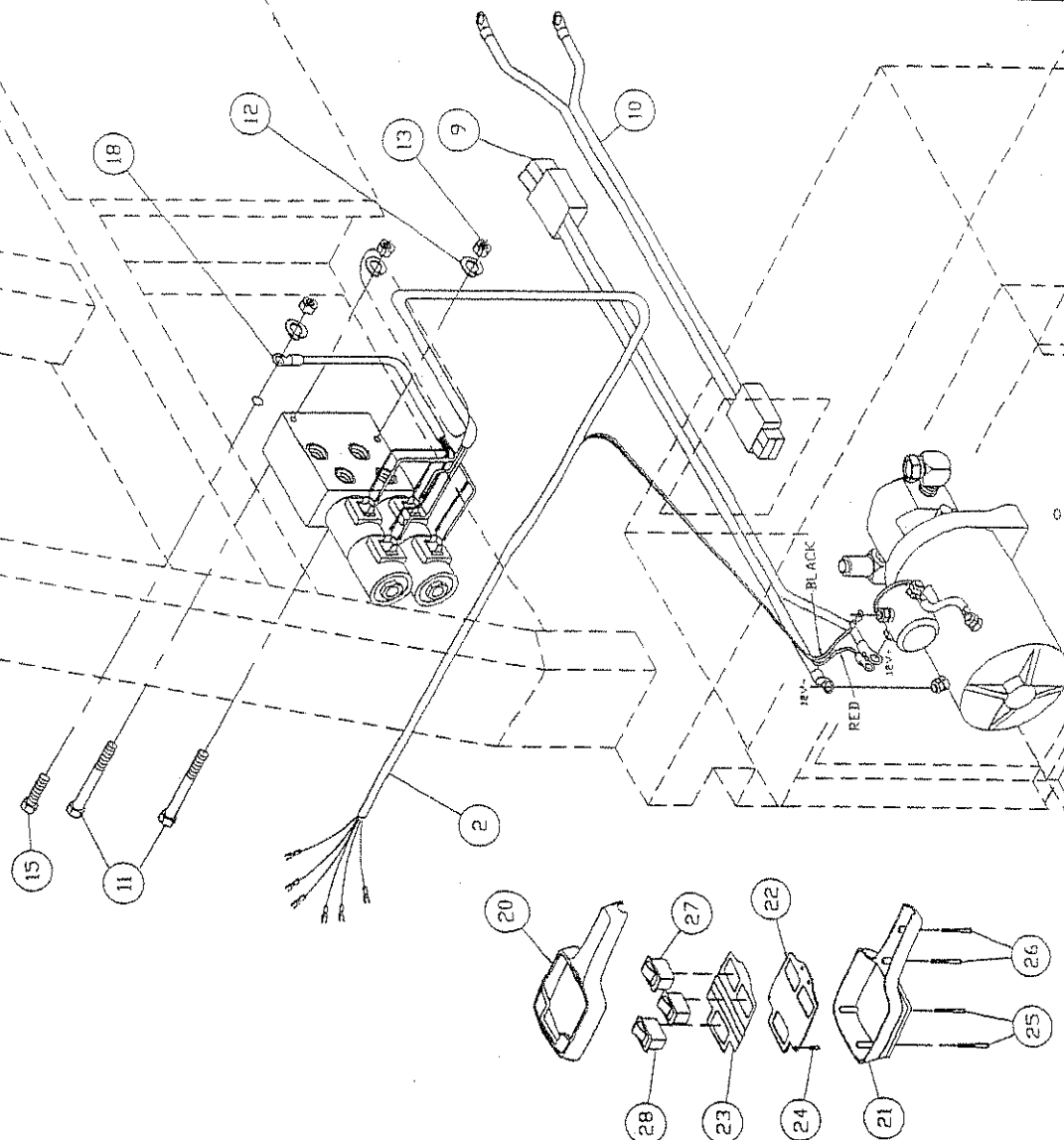
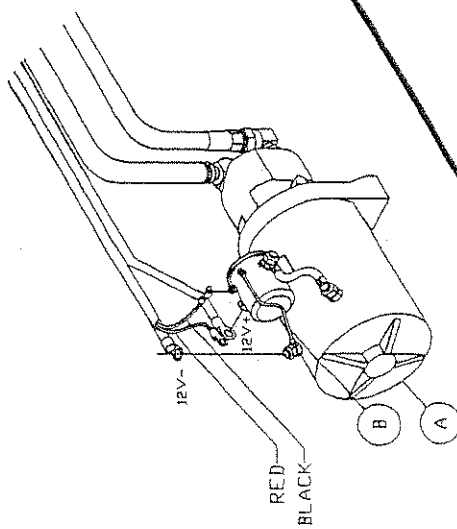

# DECAL LOCATION

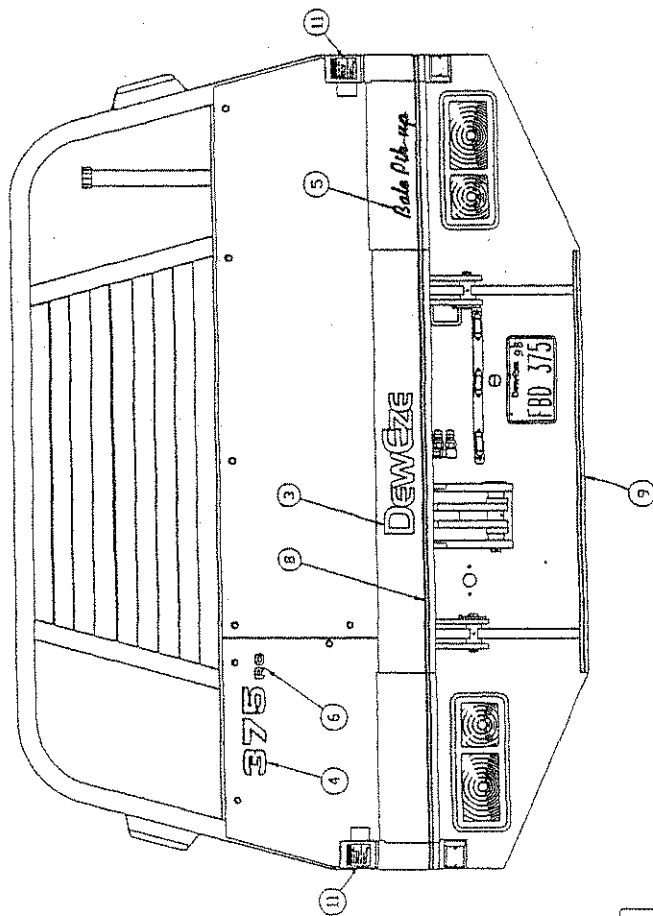

ITEM	PART NO.	DESCRIPTION
1	200131	STRIPE/L HUGGER ARM
2	200132	STRIPE/R HUGGER ARM
3	200105	DEWEZE/SILVER
4	200106	378502 (MODEL NO.)
5	200137	BALE PIK-UP/SILVER SCRIPT
*6	200108	RC
7	100478	STRIPING/SIDE RAIL
8	200012	RED/SILVER PINSTRIPE
9	200011	SILVER PINSTRIPE
10	200010	DANGER DECAL/HORIZONTAL
11	200144	DANGER DECAL/VERTICAL
	200138	DECAL KIT (ALL ABOVE DECALS)

\* USED WITH REMOTE CONTROL ONLY

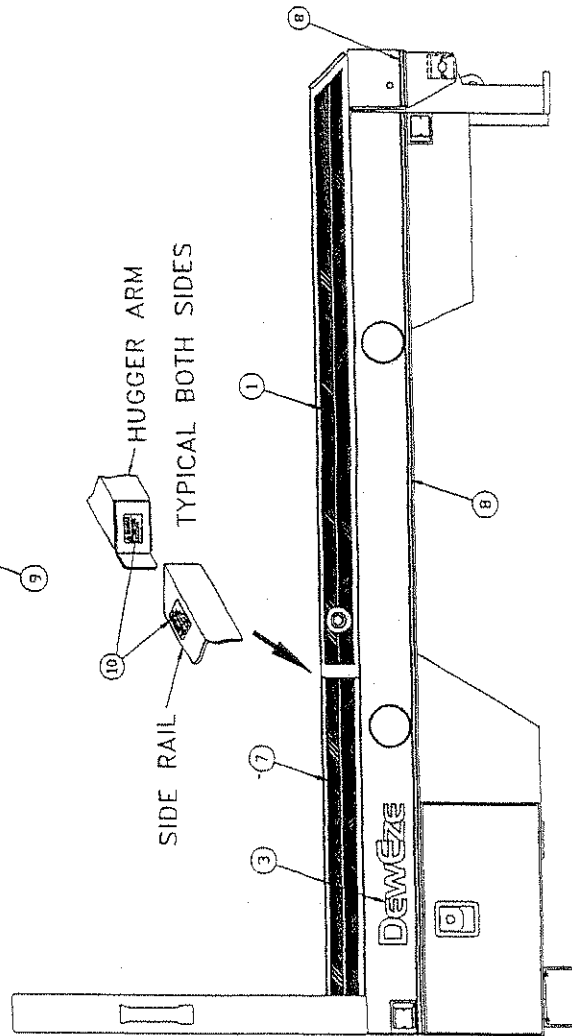
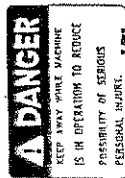
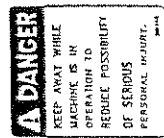

IT IS THE OWNER'S RESPONSIBILITY TO REPLACE MISSING OR DAMAGED WARNING DECALS. DECALS ARE AVAILABLE FROM YOUR DEALER OR FROM THE DEWEZE FACTORY.

200138

# SPINNERS, RISERS, LIFT BAR AND FOUR FOOT BALE ADAPTER

Figure 22

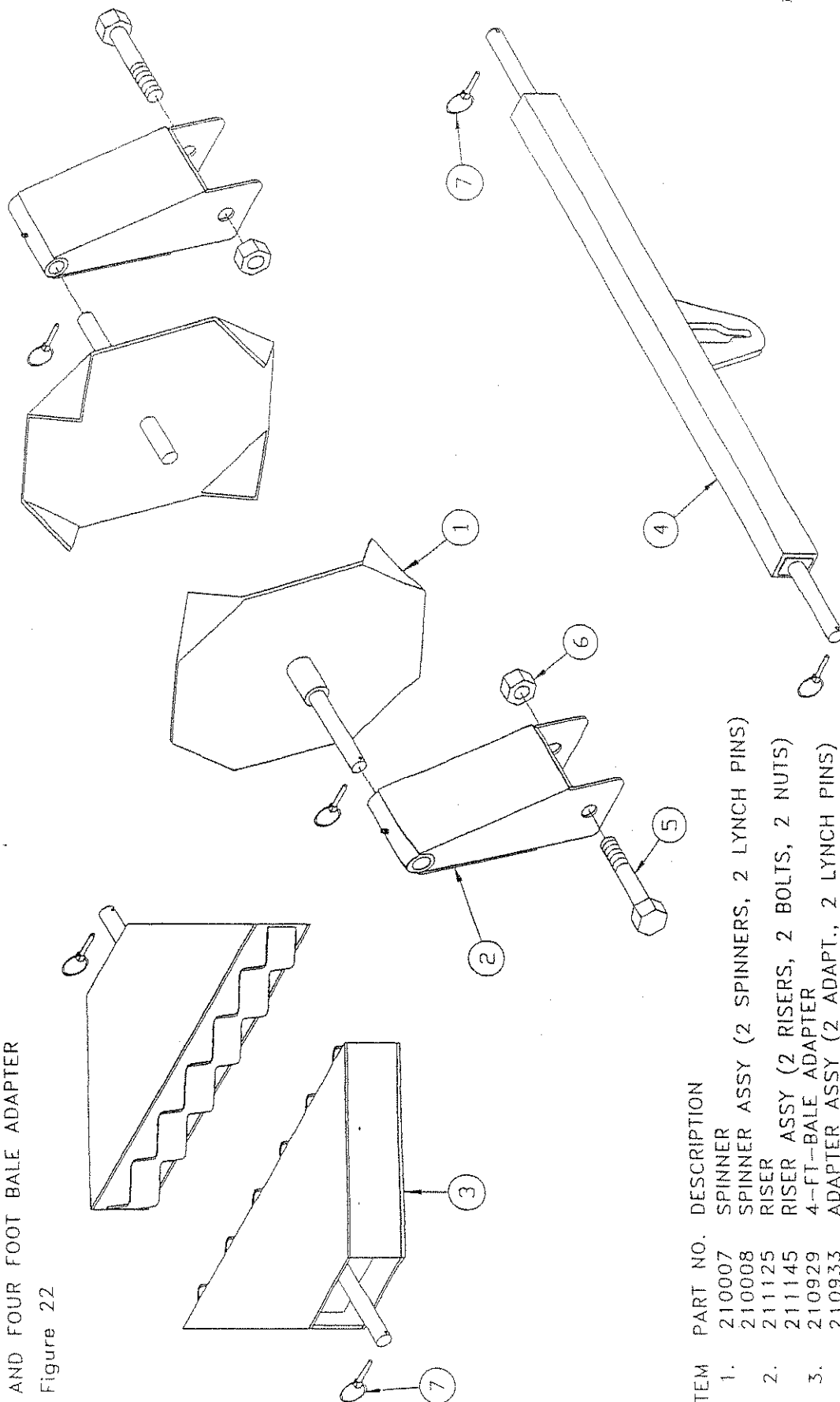

ITEM	PART NO.	DESCRIPTION
1.	210007	SPINNER
2.	210008	SPINNER ASSY (2 SPINNERS, 2 LYNCH PINS)
3.	211125	RISER
4.	211145	RISER ASSY (2 RISERS, 2 BOLTS, 2 NUTS)
5.	210929	4-FT-BALE ADAPTER
6.	210426	ADAPTER ASSY (2 ADAPT., 2 LYNCH PINS)
7.	200021	LIFT BAR
	210426	1NC X 7.00 BOLT
	210426	1NC NUT
	210006	LYNCH PIN

200160

# ELECTRIC SCHEMATIC/REMOTE CONTROL

ANTENNA  
NOT  
CONNECTED

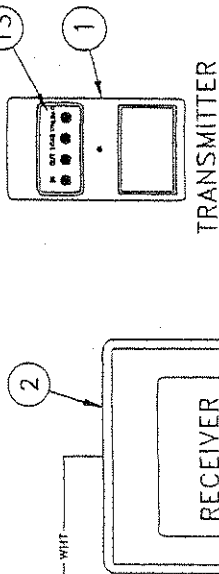

## CODE SWITCH SETTINGS

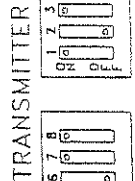
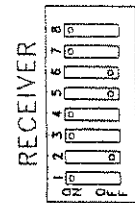

THIS SET OF SWITCHES  
UNDER REAR COVER

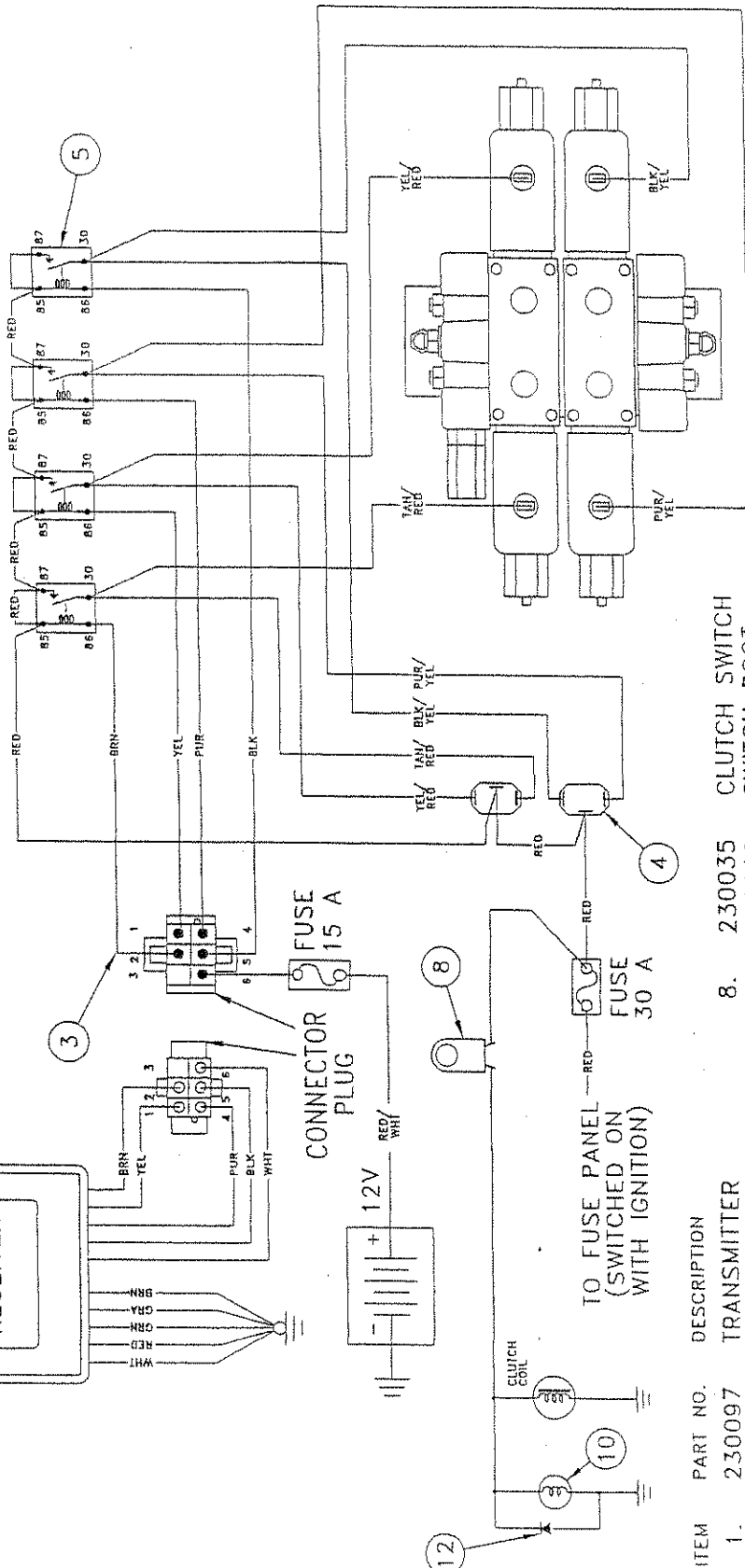

ITEM	PART NO.	DESCRIPTION
1.	230097	TRANSMITTER
2.	230106	RECEIVER W/PLUG
3.	230107	WIRING HARNESS
4.	530020	SWITCH/MOMENTARY RELAY
5.	530111	10-24 X 1/2 SCREW
6.	510960	10-24 LOCK NUT
7.	540078	CLUTCH SWITCH
8.	230035	SWITCH BOOT
9.	530019	INDICATOR LAMP
10.	730006	FUSE HOLDER
11.	730007	DIODE
12.	130036	REMOTE DECAL
13.	200148	RC DECAL
14.	200108	

200119

# VALVE ASSEMBLY\STERLING 3-BANK

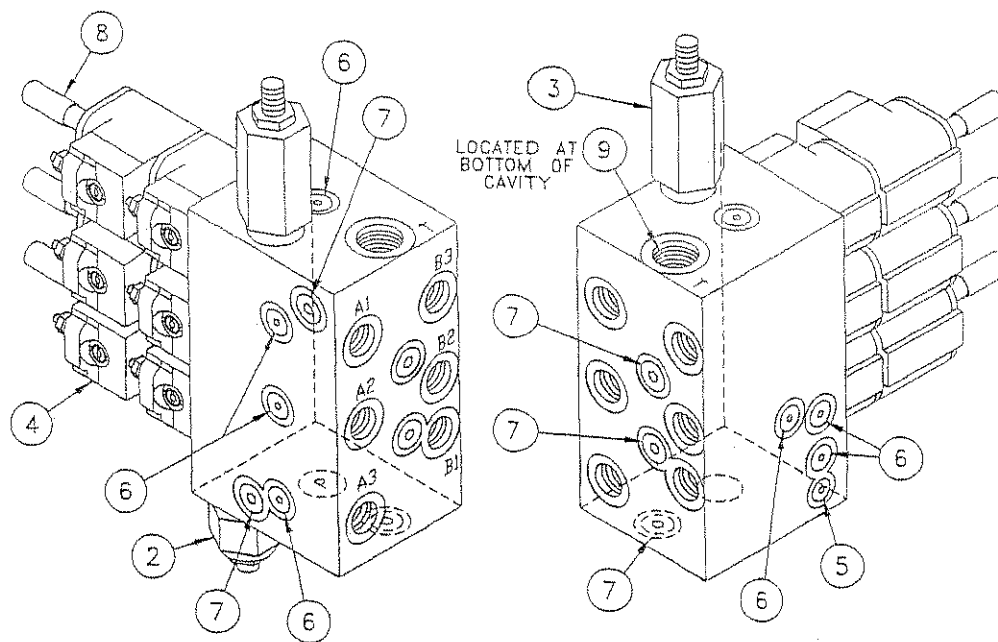

ITEM	PART NO.	DESCRIPTION
1	-----	-----
2	220536	Load control valve
3	220537	Relief valve
4	220538	Coil
5	720196	Hex plug
6	220539	Hex plug
7	720197	Hex plug
8	220540	3/4 Way solenoid valve
9	220541	Set screw

200124

